

## Basic Cabling

**⚠ CAUTION:** Before you set up and operate this product, refer to the Important Safety and Regulatory Notices document included in the shipping box.

- 1** Attach the handles to the front rack-mount tabs by aligning the handle with the round holes and fastening from the rear with the supplied screws.
- 2** Use the supplied Rack Mount Kit to mount the XPression system in a 19" EIA equipment rack.  
*For information on installing the XPression chassis in a rack, see the provided document "Installing the Chassis in a Rack".*  
*To avoid overheating, DO NOT obstruct the front air intake, rear exhaust vents, or side exhaust vent of the chassis.*
- 3** Plug the supplied Keyboard into a **USB** port.
- 4** Plug the supplied Mouse into a **USB** port.
- 5** Connect a Monitor (customer supplied) to any of the four display ports.  
*KVM extenders (customer supplied) are required when the XPression system monitor, keyboard, and mouse are located remotely from the rack room.*
- 6** Plug an Ethernet cable from your Local Area Network into one of the **Ethernet** ports (**a**) 2 x 10GbE, (**b**) 1 x 2.5GbE, (**c**) 1 x 1.0 GbE.  
*For information on the IPMI port (**d**) refer to the XPression 2RU Maintenance Guide.*  
*XPression systems can run standalone or accept a connection to a production network. The network connection is also used for the RossTalk / Smart GPI feature.*
- 7** Connect power cords from the AC ports on the XPression system to the mains power.  
*XPression system power supplies are auto-sensing and can use either 110 VAC or 220 VAC.*

Continued on other side...

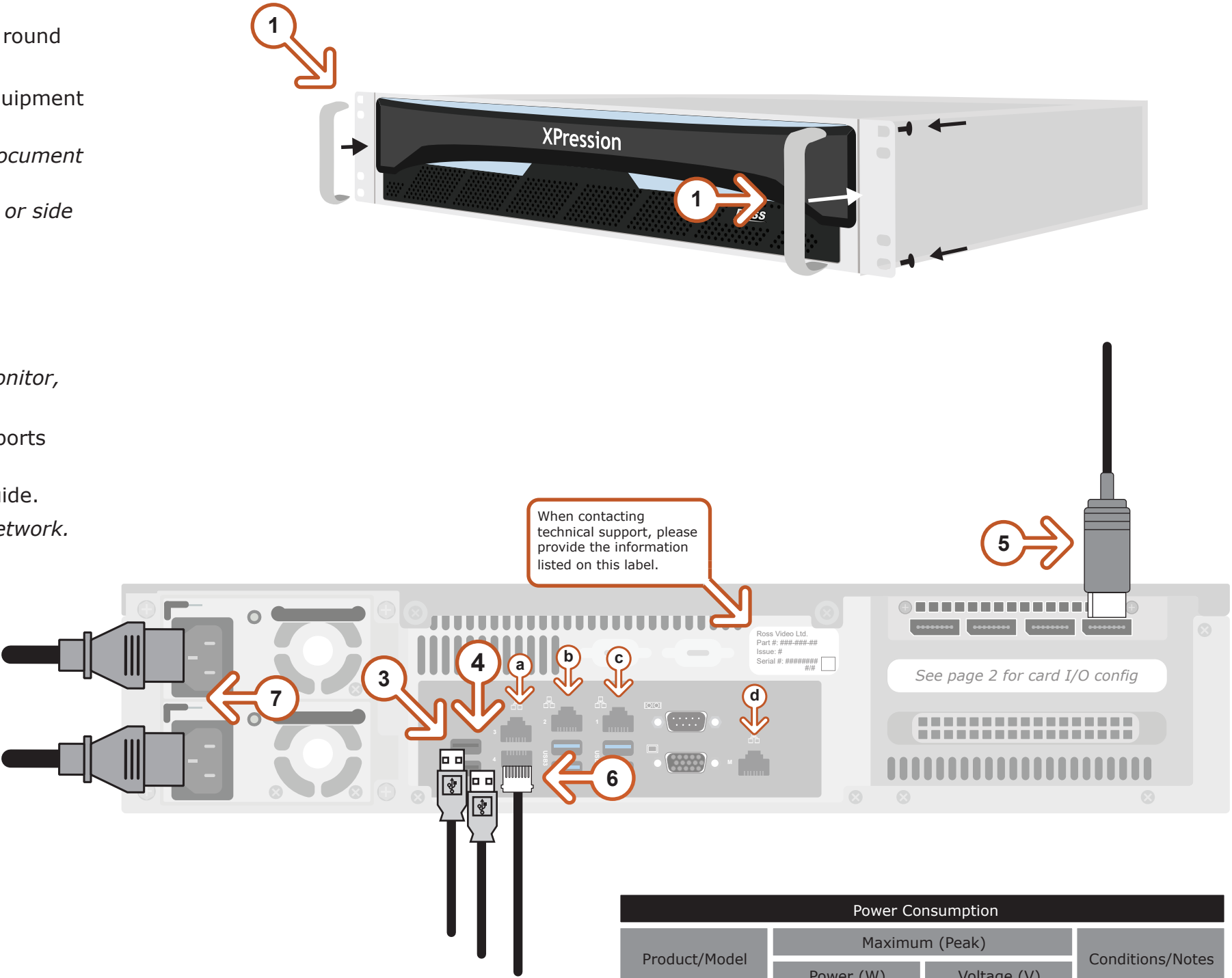

**?**

**Need Help?**

Technical Support:  
1-844-652-0645 (North America)  
+800 1005 0100 (International)  
Email: techsupport@rossvideo.com

Power Consumption			
Product/Model	Maximum (Peak)		Conditions/Notes
	Power (W)	Voltage (V)	
XPression 2RU	512	110	100% Load

## Card Cabling

### To connect the IP D25 card:

- 1** Insert a small form-factor pluggable (SFP) (customer supplied) into SFP cage 1 and attach the necessary networking cable.
- 2** If using redundancy, insert a small form-factor pluggable (SFP) (customer supplied) into SFP cage 2 and attach the necessary networking cable.
- 3** Press the **Power** button (⏻) on the front of the XPression system.  
*Ross Video recommends shutting down XPression systems from the Windows operating system.*
- 4** Click the **XPression** user account icon to log onto the system.
- 5** Launch XPression from the **Start** menu.

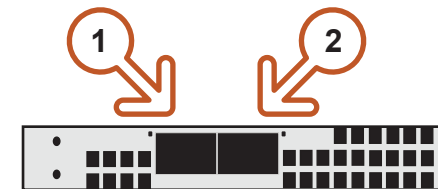

1RU and 2RU

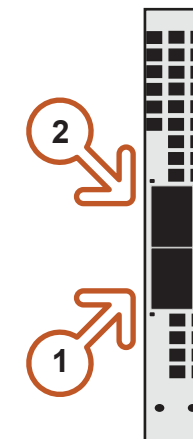

4RU

### For information on...

- operating XPression, see the "XPression User Guide" available in the C:\Archive folder
- maintenance of the XPression system, see the "XPression Maintenance Guide" in the C:\Archive folder
- other XPression features and functions, see the documents available in the C:\Archive folder